

N/F
Roman Catholic Bishop of Portland
Bk. 2321, Pg. 305

N/F
Paul A. Adams
Jean E. Adams
Bk. 2954, Pg. 552

Final Agreement
Oct. 14, 1989
P.V.-D

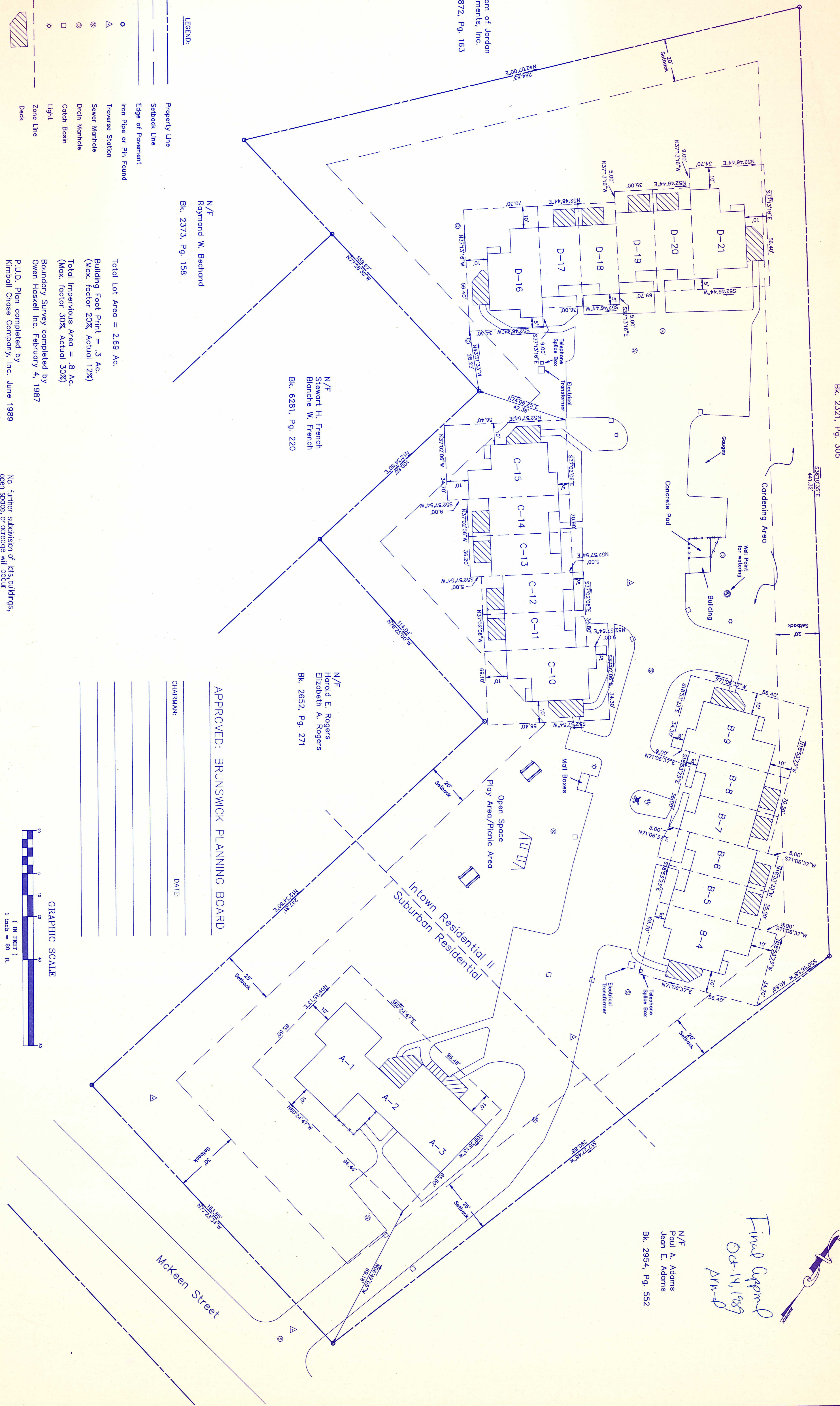

- LEGEND:**
- Property Line
 - △ Setback Line
 - ▭ Edge of Pavement
 - Iron Pipe or Pin Found
 - ⊙ Trower Station
 - ⊙ Sewer Manhole
 - ⊙ Drain Manhole
 - ⊙ Catch Basin
 - ☆ Light
 - ▨ Zone Line
 - ▨ Deck

Total Lot Area = 2.69 Ac.
Building Foot Print = .3 Ac.
(Max. factor 20%, Actual 12%)
Total Impervious Area = .8 Ac.
(Max. factor 30%, Actual 30%)
Boundary Survey completed by
Owen Haskell Inc. February 4, 1987
P.U.D. Plan completed by
Kimball Chase Company, Inc. June 1989

No further subdivision of lots, buildings,
open spaces, or coverage will occur.

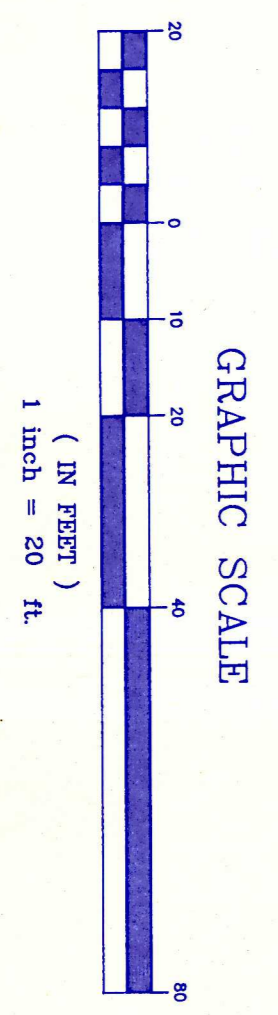

APPROVED: BRUNSWICK PLANNING BOARD

CHAIRMAN: _____
DATE: _____

REV	DATE	STATUS	BY	CHKD	APPD

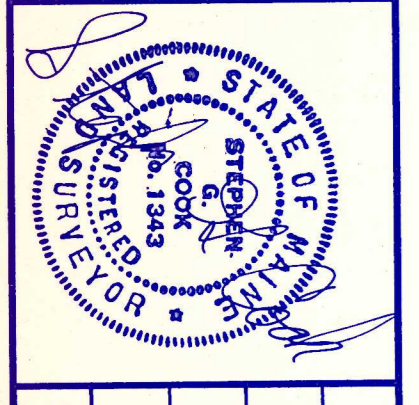

DESIGNED BY: _____
DRAWN BY: SGC
CHECKED BY: DAR
APPROVED BY: SGC
DATE: June 1989

Kimball Chase
Engineering • Surveying • Land Planning and Design
53 Front Street, Bath, ME 04530 • (207)443-1361
Portsmouth, NH • Salem, NH • Concord, NH • Hingham, MA

CLIENT
Scott & Valerie Howard
28 Sparwell Extension
Brunswick, Maine

PROJECT
Sunfield Apartments
McKeen Street, Brunswick, Me.
TITLE
Planned Unit Development

SCALE
1"=20'
PROJECT NO.
87-1722.01
DRAWING NO.
SHT. 1 of 1